



INSTRUCTIONS: POPSF4

Counter Display

Trivets

Includes:

- A. Header (1)
- B. Side Panels (2)
- C. Shelves (3)
- D. Bottom Shelf (1)
- E. Shelf Backers (3)
- F. Front Lip (1)



15.375"W x 16.25"H x 17.375"D

Notes:

- One person assembly
- There is a difference between the regular shelves and the bottom shelf. The bottom shelf has a dual rounded middle tab, as shown in picture D.



Header

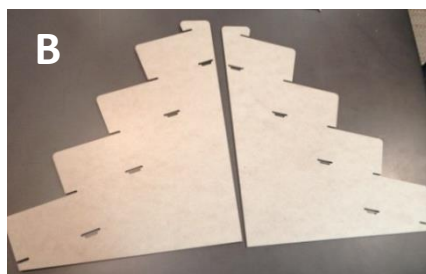

Side Panels

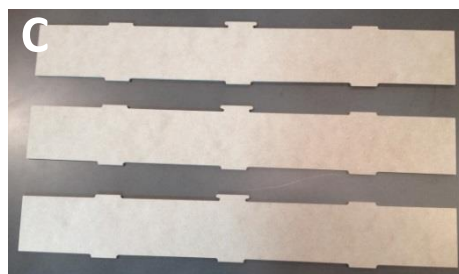

Shelves



Bottom Shelf



Shelf Backers



Front Lip

1. Take one Side Panel (B) and place into the side tab of Header (A), aligning grooves. Assure bottom tab of Header (A) aligns with slot on Side Panel (B) and slide into place. Repeat for the other side so both Side Panels (B) are in place and attached to the Header (A).



2. Line up one Shelf Backer (E) with each Side Panel (B), aligning grooves. Make sure bottom tabs of Shelf Backer (E) align with slots on Side Panels (B) and slide into place. Repeat for the next two Shelf Backers (E).

Note: Make sure Shelf Backer (E) is completely in line with the slots on the Side Panels (B). It is easier to line up one side and then work on the other side.



3. Take one Shelf (C) and line up with slots on the Shelf Backer (E). Make sure the flat tab faces the front of the display, slide tabs into place. Repeat for next two Shelves (C).

Note: You may need to pull out on the Shelf Backer (E) to get the Shelf (C) to align correctly.

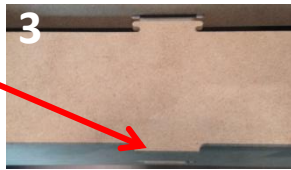

4. Attach the Bottom Shelf (D) to the Front Lip (F) before attaching to rest of display. Once together, slide into front grooves of Side Panels (B). Assure rounded tab is inserted in the Shelf Backer (E) and slide into place.



5. Congratulations! Display is ready to load with product.

